

WSTLUR WORLD SOCIETY FOR TRANSPORT &
LAND USE RESEARCH

Program



WORLD SYMPOSIUM ON TRANSPORT & LAND USE RESEARCH

Brisbane - Australia

July 3 - 6, 2017

Dear WSTLUR 2017 participants,

Welcome to Brisbane! We hope you enjoy this third triennial World Symposium on Transport and Land Use Research and that this forum provides a stimulating exchange of ideas, leads to new research, and cultivates an international network to grow and sustain our organization as well as your individual research.

This 2017 conference features two 'spotlight' themes of technological change and equity in addition to an exploration of a wide range of land use and transportation issues. The spotlight will focus on how technological change may influence the development of land use and transportation systems in the future. What equity issues will emerge via future changes in land use and transportation systems and how might these be evidenced and integrated into policy? How do technology and equity relate in the context of land use and transportation systems?

Our internationally renowned plenary speakers – Eric Miller (University of Toronto), Billie Giles-Corti (University of Melbourne), Becky P.Y. Loo (University of Hong-Kong), and Rob Adams (Director of City Design, City of Melbourne) – will activate our thinking about the future directions of transport and land use research. Peter Newman will lead an informal and engaging book club discussion around his book, "The End of Automobile Dependence: How Cities are Moving Beyond Car-Based Planning," (co-authored by Jeffrey Kenworthy). Workshops will cover land use and urban rail in China, compact cities and active transportation, women in transport leadership, and other emerging land use and transportation topics. Finally, to make sure that you have time to experience and learn more about Brisbane, we have several excellent technical and recreational tours planned.

This international gathering is the result of a large commitment of time and resources from many people. It has been our pleasure to work with our local hosts Matthew Burke of Griffith University and Neil Sipe of the University of Queensland, and the members of the organizing and technical committees. The Journal of Transport and Land Use, the official journal of WSTLUR, and editor in chief David Levinson are invaluable partners in this endeavor. Yingling Fan of the University of Minnesota coordinated the registration process, Arlene Mathison of the University of Minnesota maintained the symposium website, and Genevieve Boisjoly and Emily Grise of McGill University finalized the program. We were fortunate to have sponsorship for the symposium and the publications in JTLU from several organizations including: the University of Sydney, Griffith University, National Center for Sustainable Transportation at the University of California Davis, Center for Transportation Studies at the University of Minnesota, University of California Transportation Center, UCConnect, Brisbane City, and the Queensland Government. Thanks to all!

We look forward to seeing you over the course of the symposium – in sessions or traveling Brisbane by foot, bicycle, rail, bus, or water taxi! Enjoy the symposium and our lovely host city!

Corinne Mulley ***Ahmed El-Geneidy*** ***João de Abreu e Silva*** ***Robert Schneider***
WSTLUR Chair ***WSTLUR Vice Chair*** ***Symposium Co-Chair*** ***Symposium Co-Chair***

June, 8th 2017

THANK YOU TO OUR SPONSORS!



Dedicated to a better Brisbane



**Queensland
Government**



THE UNIVERSITY OF
SYDNEY



CENTER FOR
TRANSPORTATION STUDIES
UNIVERSITY OF MINNESOTA



**National Center
for Sustainable
Transportation**



University of California Center on
Economic Competitiveness in Transportation

	3-July-17 Conference Day 1	4-July-17 Conference Day 2	5-July-17 Conference Day 3	6-July-17 Conference Day 4
8:00	Registration (8:00-9:00)			
9:00	Opening address and keynote 1 (9:00-10:30) Eric Miller	Keynote 2 (9:00-10:30) Billie Gilles-Corti	Keynote 3 (9:00-10:30) Becky P.Y. Loo	Technical tours (9:00-12:30)
10:30	Coffee break (10:30-11:00)			
11:00	Panel sessions (11:00-11:40)	Panel sessions (11:00-11:40)	Panel sessions (11:00-11:40)	
	Panel sessions (11:45-12:30)	Panel sessions (11:45-12:30)	Panel sessions (11:45-12:30)	
12:30	Lunch (12:30 - 14:00)			
14:00	Panel sessions (14:00-14:40)	Panel sessions (14:00-14:40)	Workshops (14:00-17:00) <ul style="list-style-type: none"> ○ Compact cities ○ New trends in land use-transport studies ○ Land use and urban rail ○ Women in transport roundtable 	Tourist activity (13:20-17:00)
	Panel sessions (14:45-15:30)	Panel sessions (14:45-15:30)		
15:30	Coffee break (15:30-16:00)			
16:00	Parallel activities (16:00 - 18:15) <ul style="list-style-type: none"> ○ Book club ○ PhD Thesis Award Competition ○ Land Use & High Speed Rail ○ Transportation & Land Use Planning in Brisbane 	Panel sessions (16:00-16:40)		
17:00		Panel sessions (16:45-17:30)	Break (17:00-17:30)	
17:30			Closing Session (17:30-18:30)	
18:00				
18:30			Break (18:30-19:00)	
19:00			Dinner and keynote 4 Rob Adams (19:00 - 21:00)	

keynote sessions

Panel sessions

Technical tours and activities

Park Regis Rooms

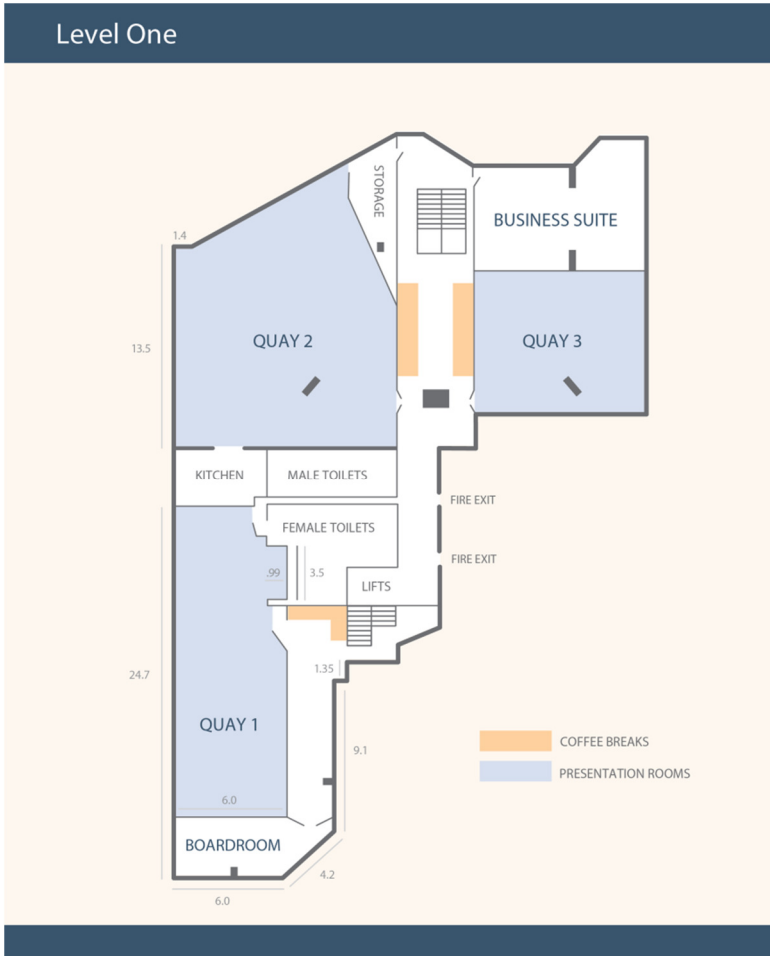

July 3rd 2017
CONFERENCE DAY 1

REGISTRATION (8:00-9:00)

Quay 2: Opening address and keynote 1 (9:00-10:30)
Opening address by Lord Mayor of Brisbane Graham Quirk
Keynote 1: Eric Miller

Coffee break (10:30-11:00)

Panel sessions (11:00-11:40)
Quay 1: Equity in transport - A
Quay 2: Emerging transportation and land use issues in Asia - A
Quay 3: Accessibility - A
Quay 4: Technological change - A

Panel sessions (11:45-12:30)
Quay 1: Equity in transport - B
Quay 2: Emerging transportation and land use issues in Asia - B
Quay 3: Accessibility - B
Quay 4: Technological change - B

Lunch (12:30 - 14:00)

Panel sessions (14:00-14:40)
Quay 1: Transportation and land use systems in growing and shrinking cities - A
Quay 2: Travel behavior and satisfaction
Quay 3: Active travel - A
Quay 4: Social psychology, land use and travel behavior - A

Panel sessions (14:45-15:30)
Quay 1: Transportation and land use systems in growing and shrinking cities - B
Quay 2: Built environment and public transport planning
Quay 3: Active travel - B

Coffee break (15:30-16:00)

Book club (Peter Newman)
PhD Competition (Kelly Clifton, Susan Handy, Wesley Marshall)
Land Use & High Speed Rail Workshop (Haixiao Pan)
Transportation & Land Use Planning in Brisbane (Lindsay Enright)
(16:00 - 18:15)

 **Keynote sessions**

 **Panel sessions**

 **Technical tours and activities**

Day 1: July 3rd 2017

Registration (8:00-9:00)

Quay 2: Opening address and keynote 1 (9:00-10:30)

Opening Address by
Corinne Mulley (University of Sydney), Matthew Burke (Griffith University) and
Neil Sipe (University of Queensland)
Graham Quirk, Lord Mayor of Brisbane

Keynote address

Introduction by João de Abreu e Silva (Instituto Superior Técnico University of Lisbon)

Prof. Eric Miller
University of Toronto

Integrated urban modelling: Past, present and future

Coffee break (10:30-11:00)

PANEL SESSIONS (11:00-11:40)

Quay 1: Equity in Transport - A

Moderator: Susan Handy (University of California, Davis)

- **What is transport and land use? A critique of the ontology and ideology of an emergent field.** Matthew Burke (Griffith University), Bruce James (Griffith University), Mark Bailey (Griffith University)
- **An approach to investigating income segregation and jobs accessibility: A case study of Tallahassee, Florida.** Levon Mikaelian (Florida State University)

Quay 2: Emerging transportation and land use issues in Asia - A

Moderator: Jason Cao (University of Minnesota)

- **Planning of TOD implication for dense cities in Indian context.** Prashanth Shekar Lokku (National Institute of Technology Warangal (NITW)), CSRK Prasad (National Institute of Technology Warangal (NITW))
- **Land use of TOD and lifestyle mobility in the suburbs.** Pengjun Zhao (Peking University), Shengxiao Li (Peking University)

Quay 3: Accessibility - A

Moderator: Alexa Delbosc (Monash University)

- **Regional accessibility and mode choice in the Greater Toronto Hamilton Area.** Shoshanna Saxe (University of Toronto), Steven Farber (University of Toronto Scarborough), Eric J Miller (University of Toronto)
- **A statistical approach to comparing accessibility results: Including uncertainty in public transport sketch planning.** Matthew Wigginton Conway (Conveyal), Andrew Byrd (Conveyal), Michael van Eggermond (Singapore ETH Centre)

Quay 4: Technological change - A

Moderator: David Levinson (University of Sydney)

- **Exploring potentials of social media for transport policy making.** AHM Mehbub Anwar (University of Wollongong), Jie Yang (University of Wollongong)
- **Up and Out: The future of travel demand in and on Cities.** David Levinson (University of Sydney), Kevin J. Krizek (University of Colorado Boulder)

PANEL SESSIONS (11:45-12:30)

Quay 1: Equity in transport - B

Moderator: Susan Handy (University of California, Davis)

- **Mobility as a service for community transport in an individualised funding environment: Providing equity against the odds?** Corinne Mulley (University of Sydney), John Nelson (University of Aberdeen), Steven D Wright (University of Aberdeen)
- **Collaboration, power and public transport in a Swedish town: Living lab in Uddevalla.** Stig Westerdahl (K2/Malmö University)

Quay 2: Emerging transportation and land use issues in Asia - B

Moderator: Jason Cao (University of Minnesota)

- **Inter-generational changes in activity-travel behavior in Hong Kong: An exploratory study.** Donggen Wang (Department of Geography, Hong Kong Baptist University), Meng Zhou (Department of Geography, Hong Kong Baptist University)
- **In-depth analysis of transport and land use development from a sociologist perspective in a narrative approach to city growth: Learning from past transport and land use development in Purwokerto, Indonesia.** Probo Hardini (ITS Leeds University, Jenderal Soedirman University)

Quay 3: Accessibility - B

Moderator: David Levinson (University of Sydney)

- **Transit accessibility, land development and socioeconomic priority: A typology of planned station catchment areas in the Greater Toronto and Hamilton Area.** Steven Farber (University of Toronto Scarborough), Maria Grandez (University of Toronto)
- **Mobility tools and use: Accessibility's role in Switzerland.** Allister Loder (ETH Zurich), Kay Axhausen (ETH Zurich)

Quay 4: Technological change - B

Moderator: Alexa Delbosc (Monash University)

- **Identification of communities in the city from a multi-layer approach.** Mehmet Yildirimoglu (The University of Queensland), Jiwon Kim (The University of Queensland)
- **Home telework, travel behaviour, and land use patterns: A path analysis of British single-worker households.** João de Abreu e Silva (Instituto Superior Técnico), Patricia C. Melo (ISEG - Lisbon School of Economics & Management)

Lunch (12:30 - 14:00)

PANEL SESSIONS (14:00-14:40)

Quay 1: Transportation and land use systems in growing and shrinking cities - A

Moderator: Ahmed El-Geneidy (McGill University)

- **Impacts of high-speed rail on housing prices at multi-spatial levels.** Yu-Hsin Tsai (National Chengchi University), Yi-Chen Chen (National Chengchi University), Tzu-Chin Lin (National Chengchi University) et al.
- **The effect of light rail transit service on nearby property values: Quasi-experimental evidence from Seattle.** Michael R Ransom (Brigham Young University)

Quay 2: Travel behavior and satisfaction

Moderator: Yingling Fan (University of Minnesota)

- **A tale of two millennials.** Alexa Delbosc (Monash University), Kelcie Ralph (Rutgers University)
- **Comparing importance-performance analysis and three-factor theory in assessing rider satisfaction with transit.** Xinyu (Jason) Cao (University of Minnesota), Xiaoshu Cao (Sun Yat-Sen University)

Quay 3: Active travel - A

Moderator: Kelly Clifton (Portland State University)

- **Scofflaw bicycling: Illegal but rational.** Wes Marshall (University of Colorado Denver), Daniel Piatkowski (University of Nebraska–Lincoln), Aaron Johnson (University of Colorado Boulder)
- **Measuring the influence of grassroots interventions on static pedestrian behaviors: exploring the influence of adaptive customization in streetscape settings on pedestrian flows.** Richard Timmerman (University College London)

Quay 4: Social psychology, land use and behavior - A

Moderator: Emily Gris , McGill University

- **The road to happiness: from obtained mood during leisure trips and activities to satisfaction with life.** Jonas De Vos (Ghent University, Geography Department), Tim Schwanen (University of Oxford), Frank Witlox (Ghent University, Geography Department)
- **Commute happiness in Xi'an, China: Effects of mode, duration, and frequency.** Jing Zhu (Northwest University), Yingling Fan (University of Minnesota)

PANEL SESSIONS (14:45-15:30)

Quay 1: Transportation and land use systems in growing and shrinking cities - B

Moderator: Ahmed El-Geneidy (McGill University)

- **Estimating bid-auction models of residential location using census data with imputed household income.** Benjamin Heldt (DLR Institute of Transport Research), Pedro Donoso (Universidad de Chile), Francisco Bahamonde-Birke (DLR Institute of Transport Research) et al.
- **Announcement, construction or delivery: when does value uplift occur? Evidence from the Gold Coast Light Rail system in Australia.** Barbara T.H. Yen (Griffith University), Corinne Mulley (University Sydney), Heather Shearer (Griffith University) et al.

Quay 2: Built environment and public transport planning

Moderator: Yingling Fan (University of Minnesota)

- **Measuring public transport and built environment integration at the neighborhood scale: Towards a quantitative assessment methodology.** Christian Marti (ETH Zurich), Luca Bertolini (University of Amsterdam), Ulrich Weidmann (ETH Zurich)
- **How density, diversity, land use and neighborhood type influences bus mobility in the Swedish city of Karlstad: Mixing spatial analytic and typomorphological approaches to assess the indirect effect of urban form on travel.** Todor Stojanovski (KTH Royal Institute of Technology)

Quay 3: Active travel - B

Moderator: Kelly Clifton (Portland State University)

- **Exploring the importance of detailed environment variables in neighborhood commute mode share models.** Robert Schneider (University of Wisconsin-Milwaukee), Lingqian Hu (University of Wisconsin-Milwaukee), Joseph Stefanich (University of Wisconsin-Milwaukee)
- **How much is enough? Assessing the influence of neighborhood walkability on undertaking 10-minutes walks.** Genevieve Boisjoly (McGill University), Rania Wasfi (Université de Montréal), Ahmed El-Geneidy (McGill University)

Coffee break (15:30-16:00)

PARALLEL ACTIVITIES (16:00 TO 18:15)

- **Quay 1: Book club (Peter Newman, Moderator: Neil Sipe)**

This year's selected book is *The End of Automobile Dependence: How Cities are Moving Beyond Car-Based Planning*. One of the authors, **Peter Newman**, will join us for this event and lead a book club format discussion with participating conference attendees. If you would like to join us for the book club, then please read *The End of Automobile Dependence: How Cities are Moving Beyond Car-Based Planning* before coming to Brisbane.

About the book

Cities will continue to accommodate the automobile, but when cities are built around them, the quality of human and natural life declines. Current trends show great promise for future urban mobility systems that enable freedom and connection, but not dependence. We are experiencing the phenomenon of peak car use in many global cities at the same time that urban rail is thriving, central cities are revitalizing, and suburban sprawl is reversing. Walking and cycling are growing in many cities, along with ubiquitous bike sharing schemes, which have contributed to new investment and vitality in central cities including Melbourne, Seattle, Chicago, and New York.

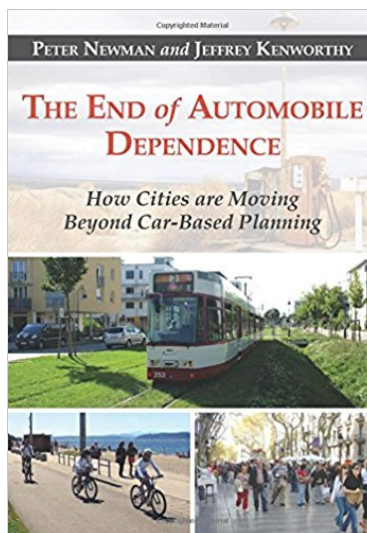

We are thus in a new era that has come much faster than global transportation experts Peter Newman and Jeffrey Kenworthy had predicted: the end of automobile dependence. In *The End of Automobile Dependence*, Newman and Kenworthy look at how we can accelerate a planning approach to designing urban environments that can function reliably and conveniently on alternative modes, with a refined and more civilized automobile playing a very much reduced and manageable role in urban transportation. The authors examine the rise and fall of automobile dependence using updated data on 44 global cities to better understand how to facilitate and guide cities to the most productive and sustainable outcomes.

This is the final volume in a trilogy by Newman and Kenworthy on automobile dependence (*Cities and Automobile Dependence* in 1989 and *Sustainability and Cities: Overcoming Automobile Dependence* in 1999). Like all good trilogies this one shows the rise of an empire, in this case that of the automobile, the peak of its power, and the decline of that empire.

- **Quay 2: PhD thesis award competition (Kelly Clifton, Susan Handy, Wesley Marshall)**

WSTLUR will be selecting a recent PhD graduates or PhD candidate to receive the Best Student Thesis Award in the field of Transport and Land Use Research. The following individuals will be presenting their thesis:

Nursitihazlin Ahmad Termida (KTH Royal Institute of Technology), "Understanding individuals' learning and decision process in a changing environment using panel data"

Kristina Currans (Portland State University, USA), "Data and methodological issues in trip generation estimate for impact analyses of urban land development"

ChengHe Guan (Harvard University), "Spatial distribution of urban territories at a regional scale: Modeling the Changjiang Delta's urban network"

Jianzheng Liu (University of Hong Kong), "Fine particulate matter in Chinese Cities: Patterns, regional transport, and mitigation"

Arefeh Nasri (University of Maryland), "The influence of urban form at different geographical scales on travel behavior: evidence from US cities"

Michael Tanko (Griffith University), "Urban ferry systems: Planning, development, and use of contemporary water-based transit in cities"

Zhanyong Wang (Shanghai Jiao Tong University), "Characterizing and modeling spatiotemporal distribution of fine particulate matter and black carbon near road intersection"

Chetan Patel (Sardar Vallbhbhai National Institute of Technology), "Mixed traffic characterization and speed-blow behavior under influence of road side friction and non-motorized vehicles: A study of arterial roads in metropolitan cities"

- **Quay 3: Land Use & High Speed Rail Workshop (Haixiao Pan)**

China has the largest high speed rail network in the world. There is a broad interest in its development and associated impacts. This workshop presents the opportunities and challenges of Chinese high speed rail networks. The following papers will be discussed:

The analysis on causes of Taiwan High speed rail falling into financial predicaments. Chaohe Rong (Beijing Jiaotong University)

High speed rail and housing price. Hongchang Li (Beijing Jiaotong University)

From TOD to HSROD: potential of land development around HSR station in different tiers of cities in China in the next 10 years. Wangtu Xu (Xiamen University)

Concentration or Dispersion? High speed rail's impact on Yangtze River Delta regional city system in China. Yina Zhang (Fudan University)

- **Quay 4: Transportation & Land Use Planning in Brisbane (Lindsay Enright)**

This presentation will provide an overview of the challenges facing our host city and the ways in which planners have tried to respond. Brisbane City Council is Australia's largest local government and takes a greater role in transport planning and transport service provision. The Council has produced many innovations in transport and land use planning including the introduction of CityCat ferries to help spur redevelopment in suburbs such as New Farm and Teneriffe, a riverwalk strategy and path investments, and an extensive high-speed busway system. As economic and lifestyle changes are today shifting travel demand, the Council is preparing a new transport plan to ensure Brisbane remains an accessible, connected city.

Mr Lindsay Enright is Program Director, Major Projects Planning within Transport Planning and Strategy at Brisbane City Council. He is playing a leading role in the development of the new transport plan for Brisbane.

July 4th 2017

CONFERENCE DAY 2

Registration (8:00-9:00)

Quay 2: Keynote 2 (9:00-10:30)

Billie Gilles-Corti

Coffee break (10:30-11:00)

Panel sessions (11:00-11:40)

Quay 1: Equity in transport - C

Quay 2: Active travel - C

Quay 3: Social psychology, land use and travel behavior - B

Quay 4: Access to and performance of public transport stations

Panel sessions (11:45-12:30)

Quay 1: Equity in transport - D

Quay 2: Active travel - D

Quay 3: Social psychology, land use and travel behavior - C

Quay 4: Transport and land use regulations in New York City, US

Lunch (12:30 - 14:00)

Panel sessions (14:00-14:40)

Quay 1: Emerging transportation and land use issues in Asia - C

Quay 2: Social psychology, land use and travel behavior - D

Quay 3: Transportation and land use systems in growing and shrinking cities - C

Quay 4: Vehicle emissions and ride sharing

Panel sessions (14:45-15:30)

Quay 1: Emerging transportation and land use issues in Asia - D

Quay 2: Social psychology, land use and travel behavior - E

Quay 3: Transportation and land use systems in growing and shrinking cities - D

Quay 4: Land use and travel behavior

Coffee break (15:30-16:00)

Panel sessions (16:00-16:40)

Quay 1: Equity in transport - E

Quay 2: Public transport ridership

Quay 3: Social psychology, land use and travel behavior - F

Panel sessions (16:45-17:30)

Quay 1: Equity in transport - F

Quay 2: Public transport in Bangkok, Thailand

Quay 3: Social psychology, land use and travel behavior - G

 **Keynote sessions**

 **Panel sessions**

 **Technical tours and activities**

Day 2: July 4th 2017

Registration (8:00-9:00)

Quay 2: Keynote 2 (9:00-10:30)

Introduction by Matthew Burke (Griffith University)

Prof. Billie Gilles-Corti

University of Melbourne

Urban design, transport and health: Are we there yet?

Coffee break (10:30-11:00)

PANEL SESSIONS (11:00-11:40)

Quay 1: Equity in transport - C

Moderator: Carey Curtis (Curtin University)

- **Does where you live affect how much you spend on transit? The link between urban form and household transit expenditures in Mexico City.** Erick Guerra (University of Pennsylvania)
- **Evaluating the transportation impacts of affordable housing: Informing development review with travel behavior analysis.** Amanda Howell (Portland State University), Kristina Currans (Portland State University), Kelly Clifton (Portland State University)

Quay 2: Active travel - C

Moderator: Robert Schneider (University of Wisconsin-Milwaukee)

- **Destinations, diversity and the choice to walk in Singapore and Switzerland.** Michael van Eggermond (Singapore ETH Centre)
- **Does the built environment influence the amount and intensity of cycling and walking?** Dick Ettema (Utrecht University)

Quay 3: Social psychology, land use and travel behavior - C

Moderator: João de Abreu e Silva (Instituto Superior Técnico)

- **Different destination, different commuting pattern? Analyzing the influence of the campus location on commuting.** David Vale (Faculty of Architecture, University of Lisbon), Mauro Pereira (University of Lisbon), Claudia Viana (University of Lisbon)
- **The effect of workplace relocation on individuals' activity travel behavior.** François Sprumont (University of Luxembourg)

Quay 4: Access to and performance of public transport stations

Moderator: Joel Franklin (KTH Royal Institute of Technology)

- **Riding to the rails: Factors underlying cycling-transit integration at commuter rail in the Greater Toronto and Hamilton Area.** Kevin Chan (University of Toronto), Steven Farber (University of Toronto Scarborough)
- **Development of a typology for station performance in a TOD network.** Runjie Huang (University of Twente), Anna Grigolon (University of Twente), Mafalda Madureira (University of Twente) et al.

PANEL SESSIONS (11:45-12:30)

Quay 1: Equity in transport - D

Moderator: Carey Curtis (Curtin University)

- **Mapping job accessibility by car and public transport in city of Cape Town, South Africa.** Imuentinyan Aivinhenyo (University of Cape Town), Mark Zuidgeest (University of Cape Town)
- **A spikier or flatter city? Assessing the convergence of job and labor accessibility.** Michael Niedzielski (Institute of Geography and Spatial Organization, Polish Academy of Sciences/University of North Dakota), Marcin Stępniaak (Institute of Geography and Spatial Organization, Polish Academy of Sciences), Amanda Hefner (University of North Dakota) et al.

Quay 2: Active travel - D

Moderator: Robert Schneider (University of Wisconsin-Milwaukee)

- **If we build it, who will benefit? A multi-criteria analysis for the prioritization of new bicycle lanes in Quebec City, Canada.** Emily Grise (McGill University), Ahmed El-Geneidy (McGill University)
- **Get on your UP bikeshare bikes: how can universities support sustainable mobility cultures?** Iderlina Mateo-Babiano (University of Melbourne), Miguel Mercado (University of the Philippines), Ryan Abis (University of the Philippines) et al.

Quay 3: Social psychology, land use and travel behavior - C

Moderator: João de Abreu e Silva (Instituto Superior Técnico)

- **Urban containment and inner-city densification reduce auto ownership.** Xinyu (Jason) Cao (University of Minnesota), Petter Naess (Norwegian University of Life Sciences), Fitwi Wolday (Norwegian University of Life Sciences)
- **Car ownership versus parking supply in residential apartments: A case study of Melbourne, Australia.** Geoff Rose (Monash University), Chris De Gruyter (Monash University), Gregory Pollard (Monash University) et al.

Quay 4: Transport and land use regulations in New York City, US

Moderator: Joel Franklin (KTH Royal Institute of Technology)

- **The transportation implications of land use growth allocations in the New York Metropolitan Region.** Jeffrey Zupan (Regional Plan Association), Richard Barone (Regional Plan Association)
- **Spatial regulation of taxicab services: measuring excess travel from New York City.** David King (Arizona State University), Juan Saldarriaga (Columbia University)

Lunch (12:30-14:00)

PANEL SESSIONS (14:00-14:40)

Quay 1: Emerging transportation and land use issues in Asia - C

Moderator: Arlie Adkins (University of Arizona)

- **Public transport use among the elderly: Effects of personal, attitudinal, household, social environment and built environment factors.** Wei Wu (Changsha University of Science and Technology), Yi Zhang (Shanghai Jiao Tong University), Qian He (Shanghai Jiao Tong University) et al.
- **The effect of transport cost on housing affordability: Experiences from the Bandung Metropolitan Area, Indonesia.** Yulia Dewita (Griffith University), Barbara T.H. Yen (Griffith University), Matthew Burke (Griffith University)

Quay 2: Social psychology, land use and travel behavior - D

Moderator: Neil Sipe (University of Queensland)

- **Is bigger better? Metropolitan area population, access, activity participation, and quality of life.** Eric A. Morris (Clemson University), Andrew Mondschein (University of Virginia), Evelyn Blumenberg (UCLA Luskin School of Public Affairs)
- **Discourses and travel behaviour in London: Applying Q methodology.** Robin Hickman (UCL)

Quay 3: Transportation and land use systems in growing and shrinking cities - C

Moderator: David Levinson (University of Sydney)

- **Dynacity: An irregular cellular automata-based land use and transportation interaction modeling tool for urban planning and decision making.** Shaopeng Zhong (Dalian University of Technology), Bo Yu (Chongqing Transport Planning Institute), Haimin Jun (Dalian Urban Planning & Design Institute)
- **Integrating activity-based accessibility into land use modelling in SimMobility.** Diem Trinh Le (Singapore - MIT Alliance for Research and Technology), Roberto Ponce Lopez (MIT), Jingsi Shaw (MIT) et al.

Quay 4: Vehicle emissions and ride sharing

Moderator: Billie Gilles-Corti (University of Melbourne)

- **Decarbonization of vehicle fleet through land use: Examining the beneficial effects of "3Ds" on urban vehicle fuel efficiency.** Tiebei Li (RMIT University), Jago Dodson (RMIT University)
- **Car Sharing, complaints and coping: do mobility transitions need willingness?** Jennifer Kent (The University of Sydney)

PANEL SESSIONS (14:45-15:30)

Quay 1: Emerging transportation and land use issues in Asia - D

Moderator: Arlie Adkins (University of Arizona)

- **Willingness to change car use under a tradable driving credit scheme: A comparison between Beijing and the Netherlands.** Nico Dogterom (Utrecht University), Yue Bao (Beijing Jiaotong University), Meng Xu (Beijing Jiaotong University) et al.
- **Assessing the stated preference of transit users in Abu Dhabi.** Praveen Kumar Maghelal (Masdar Institute), Mayada Almardood (Masdar Institute)

Quay 2: Social psychology, land use and travel behavior - E

Moderator: Neil Sipe (University of Queensland)

- **Transport disadvantage, social exclusion and subjective wellbeing: The role of the neighbourhood environment - Evidence from Sydney, Australia.** Liang Ma (RMIT), Jennifer Kent (The University of Sydney), Corinne Mulley (University of Sydney)
- **A lifestyle-based model of household neighbourhood location and individual travel mode choice behaviours.** Ali Ardeshiri (University of South Australia), Akshay Vij (University of South Australia)

Quay 3: Transportation and land use systems in growing and shrinking cities - D

Moderator: David Levinson (University of Sydney)

- **Analysing the spatial location of employment centres relative to residential areas in Cape Town: A spatial metrics approach.** Hazvinei Tsitsi Tamuka Moyo (University of Cape Town), Mark Zuidgeest (University of Cape Town)
- **Corridor transit oriented development: Land use optimization based on Multi-Objective Genetic Algorithms.** Ming Zhang (Wuhan University/University of Texas at Austin), Hongzan Jiao (Wuhan University), Zhang Wenjia (University of North Carolina at Charlotte)

Quay 4: Land use and travel behavior

Moderator: Billie Gilles-Corti (University of Melbourne)

- **Linking residential location, transport rationales and time geography across metropolitan contexts.** Petter Naess (Norwegian University of Life Sciences), Sebastian Peters (Norwegian University of Life Sciences), Arvid Strand (Institute of Transport Economics)
- **Land Use Change at the Station Areas of Bus Rapid Transit: A Case Study of Brisbane.** Svitlana Pyrohova (The University of Queensland), Mark Hickman (The University of Queensland), Kelly Bertolaccini (University of Queensland)

Coffee break (15:30 - 16:00)

PANEL SESSIONS (16:00-16:40)

Quay 1: Equity in transport - E

Note: This session ends at 17:00.

Moderator: Corinne Mulley (University of Sydney)

- **Contextualizing walkability: Differences in built environment associations with walking and physical activity across socioeconomic contexts.** Arlie Adkins (University of Arizona), Carrie Makarewicz (University of Colorado Denver), Michele Scanze (University of Arizona) et al.
- **Coordinating transit planning and workforce development: Exploring practitioners' shared understandings.** Yingling Fan (University of Minnesota), Andrew Guthrie (University of Minnesota), Fernando Burga (University of Minnesota)
- **Social categories in national transport planning.** Karin Winter (KTH Royal Institute of Technology)

Quay 2: Public transport ridership

Moderator: Geneviève Boisjoly (McGill University)

- **Census, routing & scheduling, and stop characteristics associated with regional transit ridership.** Douglas Moody (City of San Jose, CA), Anurag Pande (Cal Poly San Luis Obispo), Robert Bertini (University of South Florida) et al.
- **Ridership and the built-form indicators: A study from Ahmedabad Janmarg Bus Rapid Transit System.** Rabiul Islam (Chittagong University of Engineering & Technology), Mark Brussel (University of Twente), Anna Grigolon (University of Twente) et al.

Quay 3: Social psychology, land use and travel behavior - F

Moderator: Matthew Burke (Griffith University)

- **Intrapersonal day-to-day travel variability, transit accessibility and duration of household travel surveys.** Wei Li (Texas A&M University), Douglas Houston (University of California, Irvine), Marlon Boarnet (University of Southern California) et al.
- **Changes in travel behavior during the transition from secondary to higher education.** Leen De Paepe (Ghent University), Veronique Van Acker (Luxembourg Institute of Socio-Economic Research), Frank Witlox (Ghent University), Jonas De Vos (Ghent University)

PANEL SESSIONS (16:45-17:30)

Quay 1: Equity in transport – F (continued, 16:00-17:00)

Moderator: Corinne Mulley (University of Sydney)

Quay 2: Public transport in Bangkok, Thailand

Moderator: Geneviève Boisjoly (McGill University)

- **Attitude towards walking to transit station of rail users living near station: A case study of Transit-Oriented Developments (TODs) in Bangkok, Thailand.** Pornraht Pongprasert (Graduate school of Science and Engineering, Saitama University, Japan), Hisashi Kubota (Saitama University)
- **Passenger ferry modernisation in an era of mass rapid transit: the uncertain future of the Chao Phraya Express Boat service in Bangkok.** Michael Tanko (KTH Royal Institute of Technology)

Quay 3: Social psychology, land use and travel behavior - G

Moderator: Matthew Burke (Griffith University)

- **Trip generation rate analysis with missing data: A comparison of handling methods, and effects of percent missing values and sample sizes.** Sutthipong Meeyai (Suranaree University of Technology)
- **Optimizing mobile device gps data collection to capture long distance travel.** Benjamin Kaufman (University of Vermont), Gillian Galford (University of Vermont)

July 5th 2017
CONFERENCE DAY 3

Registration (8:00-9:00)

Quay 2: Keynote 3 (9:00-10:30)
Becky P.Y. Loo

Coffee break (10:30-11:00)

Panel sessions (11:00-11:40)
Quay 1: Emerging transportation and land use issues in Asia - E
Quay 2: Technological change - C
Quay 3: Equity in transport - G

Panel sessions (11:45-12:30)
Quay 1: Emerging transportation and land use issues in Asia - F
Quay 2: Accessibility - C
Quay 3: Equity in transport - H

Lunch (12:30 - 14:00)

Workshops (14:00-17:00)
Quay 1: Compact cities - Are they the route to healthy and sustainable urban futures?
(Corinne Mulley and Ahmed El-Geneidy)
Quay 2: New trends in land use and transport studies (Ming Zhang)
Quay 3: Land use and urban rail (Jason Cao)
Quay 4: Women in transport roundtable (Iderlina Mateo-Babiano)

Break (17:00-17:30)

Quay 2: Closing session (17:30-18:30)

Break (18:30-19:00)

Dinner and keynote 4 (19:00 - 21:00)
Rob Adams
Deery's Restaurant

 **Keynote sessions**

 **Panel sessions**

 **Technical tours and activities**

Day 3: July 5th, 2017

Registration (8:00-9:00)

Quay 2: Keynote 3 (9:00-10:30)

Introduction by Robert James Schneider (University of Wisconsin-Milwaukee)

Prof. Becky P.Y. Loo

University of Honk Kong

From negative transport externalities to sustainability: What are the ways forward?

Coffee break (10:30-11:00)

PANEL SESSIONS (11:00-11:40)

Quay 1: Emerging transportation and land use issues in Asia - F

Moderator: Erick Guerra (University of Pennsylvania)

- **Accommodating pedestrian and bicycle travel: The guidelines of planning and design for non-motorized transportation in City of Dongguan, China.** Hongbo Du (Dongguan Urban Planning and Design Institute), Wenshi Sun (Dongguan Urban Planning and Design Institute), Xiaoyong Qiu (Dongguan Urban Planning and Design Institute)
- **Do I walk or ride the rickshaw? Examining the factors affecting the first and last mile trip options in historic districts of the global South.** Alexis Fillone (De La Salle University), Iderlina Mateo-Babiano (University of Melbourne), Jose Roberto Bongulto (De La Salle University) et al.

Quay 2: Technological change - C

Moderator: Ming Zhang (University of Texas)

- **From land use to lane use - Bicycling to change urban transport.** Kevin J. Krizek (University of Colorado Boulder), David Levinson (University of Sydney)
- **Investigation of the impact of social networking and transport-support applications on weekend travel.** Nazmul Arefin Khan (Dalhousie University), Muhammad Ahsanul Habib (Dalhousie University), Shaila Jamal (Dalhousie University)

Quay 3: Equity in transport - G

Moderator: Iderlina Mateo-Babiano (University of Melbourne)

- **The incidence of transport benefits for new public transport infrastructure: Winners and losers in the locality of the Sydney Metro North West.** Corinne Mulley (University of Sydney), Geoffrey Clifton (ITLS, University of Sydney)
- **Spatial accessibility of public transport in Australian cities: does it relieve or entrench social and economic inequality?** Jan Scheurer (Curtin University/RMIT University), Carey Curtis (Curtin University)

PANEL SESSIONS (11:45-12:30)

Quay 1: Emerging transportation and land use issues in Asia - F

Moderator: Erick Guerra (University of Pennsylvania)

- **Exploring correlates of passenger satisfaction and service improvement priorities of the Shanghai-Nanjing high speed rail.** Feng Zhen (Nanjing University), Jason Cao (University of Minnesota), Jia Tang (Nanjing University)
- **Economic spaces and mobility nodes: Exploring the relationship of urban informal trading to transport and land use.** Redento Bolivar Recio (University of Queensland), Sonia Roitman (University of Queensland), Iderlina Mateo-Babiano (University of Melbourne)

Quay 2: Accessibility - C

Moderator: Ming Zhang (University of Texas)

- **Exploring links between the sustainability performance of urban public transport and land use in international cities.** Graham Currie (Monash University), Chris De Gruyter (Monash University)
- **Full cost analysis of accessibility.** Mengying Cui (University of Minnesota), David Levinson (University of Sydney)

Quay 3: Equity in transport - H

Moderator: Iderlina Mateo-Babiano (University of Melbourne)

- **Effects of contemporary light rail on private transport energy use and oil vulnerability: a longitudinal assessment of Gold Coast City 2009-2015.** Abraham Leung (Griffith University), Matthew Burke (Griffith University), Barbara T.H. Yen (Griffith University) et al.
- **An analysis of changes to transit accessibility and equity after the opening of a bus rapid transit system in Hartford, Connecticut.** Kelly Bertolaccini (The University of Queensland)

Lunch (12:30 - 14:00)

WORKSHOPS (14:00-17:00)

Quay 1: Compact cities - Are they the route to healthy and sustainable urban futures?

Moderator: Corinne Mulley (University of Sydney) and Ahmed El-Geneidy (McGill University)

More walking and less driving gives a healthier future. Is changing the built environment enough to create a change in driving behavior? Do we need to understand better what drives the decision to locate in compact versus more suburban spaces? What sort of studies would provide better evidence for policy to create a healthier future? The following panelists will start the discussion:

- Susan Handy (UC Davis)
- Marlon Boarnet (University of Southern California)
- Jennifer Kent (University of Sydney)
- João de Abreu e Silva (Instituto Superior Técnico)

Quay 2: New trends in land use and transport studies

Moderator: Ming Zhang (University of Texas at Austin)

The workshop highlights advances in land use-transport studies reported from a variety of efforts. Topics include empirical updates, applications of new technologies, latest calibration of integrated land use-transport models, and case study of land use-transport policies and practices. The following paper will be discussed:

- **Can policy invoke sub-centres? Evaluation of Melbourne's urban spatial planning since 1981.** Jennifer Day (The University of Melbourne), Lyra Han (The University of Melbourne), Ivy Hu (University of Wisconsin-Milwaukee), and Amy Wu (The University of Melbourne).
- **The change of commuting to the employment centers of large US metropolitan areas, 1990-2010.** Qisheng Pan (Tongji University)
- **Mobility and travel behavior in hyper-dense cities: A research agenda.** Donggen Wang (Hong Kong Baptist University)
- **Cultural, organizational and technical challenges and mitigating solutions in designing and developing pecas models for city of Shanghai and Wuhan.** Ming Zhong (Wuhan University of Technology), John Douglas Hunt (University of Calgary), and Haixiao Pan (Tongji University)
- **Drones, mobile sensors, and the transport-land use-air quality nexus.** Zhongren Peng (University of Florida)
- **Innovations in land use and transit development in Shenzhen, China.** Zhengdong Huang (Shenzhen University)

Quay 3: Land use and urban rail

Moderator: Jason Cao (University of Minnesota)

This workshop presents the ongoing discussion on land use and transportation interactions in China, particularly metro transit which has proliferated during the past decade. The following papers will be discussed:

- **Shopping travel around metro station in Shanghai suburban area.** Haixiao Pan (Tongji University)
- **The institutional barriers of integration of transportation and land use in China.** Jian Zhao (Beijing Jiaotong University)
- **Research on mutual relationship between metro route layout and urban land use planning.** Xi Luo (Xi'an University of Architecture and Technology)
- **The analysis of mechanism and problems of city transportation planning.** Peihong Chen (Beijing Jiaotong University)

Quay 4: Women in transport roundtable

Moderator: Iderlina Mateo-Babiano (University of Melbourne)

The transport sector plays a key role in achieving the United Nations' Sustainable Development Goal # 11, in making cities more inclusive, safe, resilient and sustainable. Often overlooked, however, are gender issues associated with the participation in and the interaction between transport and land use. The Women in Transport Leadership knowledge network-led roundtable convenes key change champions to discuss initiatives to address the gender, transport and land use challenge.

Panelists:

1. Professor Becky P.Y. Loo, University of Hong Kong
2. Dr. Kalpana Viswanath, Co-Founder – SafetiPin
3. Professor Roselle Leah K. Rivera, University of the Philippines
4. Mr. Joshua Hannan, General Manager – Transport Strategy and Planning, TMR
5. Kate Mackay, Principal Transport Planner, Mott Macdonald

Coffee break (17:00-17:30)

Quay 2: Closing session (17:30 – 18:30)

Robert James Schneider (University of Wisconsin-Milwaukee)
João de Abreu e Silva (Instituto Superior Técnico)
Kelly Clifton (Portland State University)
David Levinson (University of Sydney)

Break (18:30 – 19:00)

Dinner and keynote 4 (19:00 - 21:00)
Introduction by Corinne Mulley (University of Sydney)

Keynote: Rob Adams
Director of City Design
City of Melbourne

Transforming Australian capital cities: New or reuse?

Deery's Restaurant
Storey Bridge Hotel
200 Main St
Kangaroo Point

Please note that this is on the other side of the Brisbane river from the conference venue. You may wish to use the free CityHopper ferry service (www.brisbane.qld.gov.au/traffic-transport/public-transport/citycat-ferry-services/cityhopper)

July 6th 2017
CONFERENCE DAY 4

**Technical tours
(9:00-12:30)**

**Tourist activity
(13:20-17:00)**

 **Keynote sessions**

 **Panel sessions**

 **Technical tours and activities**

Day 4: July 6th, 2017

TECHNICAL TOURS (9:00 – 12:30)

All tours will depart from the hotel lobby at 9:00am

- **Brisbane's busways**
Brisbane has one of the world's largest separated busway systems operating on the 'quickway' model. Visiting the South-East and Eastern busways by bus this tour will show how the busways and stations work as well as how they link key destinations and allow rapid transit to service large residential catchments.
- **Ferry-oriented development**
Brisbane's fast CityCat and free CityHopper ferries are a major tourist drawcard. They also provide a mainstream transport option for commuters, students and others. This tour will look at the design of new flood-resistant terminals that recently won major Australian engineering awards. The fieldtrip will show how major land developments are being built around ferry stops across the city.

- **City laneways revitalisation**
This walking tour will explore how 'tactical urbanism' and urban design strategies have helped transform underutilised parts of the Brisbane central business district into vital public spaces. Public art, temporary interventions and clever design have helped generate laneway bars, cafes, and new spaces for people.
- **Brisbane's cycling renaissance**
Cycling is booming in central Brisbane since segregated infrastructure has been steadily introduced along the river and on key corridors. This bicycle tour will see riders travel to and across key facilities in the city including 'green bridges' and the Riverwalk link that created a safe and pleasant route to the suburb of New Farm.
Note that riders must bring: comfortable clothes; enclosed shoes; passport, credit card or driver's license; and if sunny we recommend sunscreen and sunglasses
- **Gold Coast light rail**
Venturing further afield, this fieldtrip will visit the nearby city of Gold Coast to look at the first 13km stage of their new light rail scheme. Attention will be placed on design issues of the stations and surrounding precincts and the pro-active planning policies employed to leverage additional land development in the corridor.

TOURIST ACTIVITY (13:20 – 17:00)

- **Visit to Lone Pine Koala Sanctuary**
12km from the centre of Brisbane the Lone Pine Koala Sanctuary is the oldest and largest koala sanctuary in the world. Visitors can get up close and personal with kangaroos, wallabies, wombats, platypuses, koalas and range of other Australian animals. We will travel by city council bus and the visit to the sanctuary will be self-directed, enabling you to return whenever you have had your fill of cute and cuddliness. Adult entry \$36; koala holding extra.
Meeting point: Park Regis hotel lobby at 13:20 sharp or Queen Street Mall Busway station platform 2C for route 430 bus departing at 13:40.

INDEX BY LAST NAME

A

ABIS, Ryan	10
ADAMS, Rob	18
ADKINS, Arlie	11, 12
AHSANUL HABIB, Muhammad	15
AIVINHENYO, Imuentinyan	10
ALMARDOOD, Mayada	11
ANWAR, Mehbub AHM	3
ARDESHIRI, Ali	12
AREFIN KHAN, Nazmul	15
AXHAUSEN, Kay	3

B

BAHAMONDE-BIRKE, Francisco	4
BAILEY, Mark	2
BAO, Yue	11
BARONE, Richard	10
BERTINI, Robert	13
BERTOLACCINI, Kelly	12, 16
BERTOLINI, Luca	5
BLUMENBERG, Evelyn	11
BOARNET, Marlon	13, 16
BOISJOLY, Genevieve	5, 13
BOLIVAR RECIO, Redento	16
BRUSSEL, Mark	13
BURGA, Fernando	12
	2, 9, 11,
BURKE, Matthew	13, 16
BYRD, Andrew	2

C

CAO, Xiaoshu	4
	2, 3, 4,
	10, 16,
CAO, Xinyu (Jason)	17
CHAN, Kevin	9
CHEN, Peihong	17
CHEN, Yi-Chen	4
CLIFTON, Geoffrey	15
	4, 5, 6,
CLIFTON, Kelly	9, 18

CUI, Mengying	16
CURRANS, Kristina	6,9
CURRIE, Graham	16
CURTIS, Carey	9, 10, 15

D

DAY, Jennifer	17
	2, 3, 9,
	10, 16,
DE ABREU E SILVA, João	18
DE GRUYTER, Chris	10, 16
DE PAEPE, Leen	13
DE VOS, Jonas	4, 13
DELBOSC, Alexa	2, 3, 4
DEWITA, Yulia	11
DODSON, Jago	11
DOGTEROM, Nico	11
DONOSO, Pedro	4
DU, Hongbo	15

E

	4, 5, 10,
EL-GENEIDY, Ahmed	14, 16
ENRIGHT, Lindsay	7
ETTEMA, Dick	9

F

FAN, Yingling	4, 5, 12
FARBER, Steven	2, 3, 9
FILLONE, Alexis	15

G

GALFORD, Gillian	13
GILLES-CORTI, Billie	9, 11, 12
GRANDEZ, Maria	3
GRIGOLON, Anna	9, 13
GRISE, Emily	4, 10
GUAN, ChengHe	6
GUERRA, Erick	9, 15, 16
GUTHRIE, Andrew	12

H

HAN, Lyra	17
-----------	----

	2, 3, 6,	LIN, Tzu-Chin	4
HANDY, Susan	16	LIU, Jianzheng	6
HANNAN, Joshua	18	LOO, Becky P.Y.	15, 18
HARDINI, Probo	3	LODER, Allister	3
HE, Qian	11	LUO, Xi	17
HEFNER, Amanda	10	M	
HELDT, Benjamin	4	MA, Liang	12
HICKMAN, Mark	12	MACKAY, Kate	18
HICKMAN, Robin	11	MADUREIRA, Mafalda	9
HOUSTON, Douglas	13	MAKAREWICZ, Carrie	12
HOWELL, Amanda	9	MARSHALL, Wes	4, 6
HU, Ivy	17	MARTI, Christian	5
HU, Lingqian	5		10, 14,
HUANG, Runjie	9		15, 16,
HUANG, Zhengdong	17	MATEO-BABIANO, Iderlina	18
HUNT, John Douglas	17	MEEYAI, Sutthipong	13
I		MELO, Patricia C.	3
ISLAM, Rabiul	13	MERCADO, Miguel	10
J		MIKAELIAN, Levon	2
JAMAL, Shaila	15	MILLER, Eric J	2
JAMES, Bruce	2	MONDSCHHEIN, Andrew	11
JIAO, Hongzan	12	MOODY, Douglas	13
JOHNSON, Aaron	4	MORRIS, Eric A.	11
K			2, 3, 4,
KAUFMAN, Benjamin	13		12, 13,
	11, 12,	MULLEY, Corinne	15, 16,
KENT, Jennifer	16		18
KIM, Jiwon	3	N	
KING, David	10	NAESS, Petter	10, 12
KRIZEK, Kevin J.	3, 15	NASRI, Arefeh	6
KUBOTA, Hisashi	13	NELSON, John	3
KUMAR MAGHELAL, Praveen	11	NEWMAN, Peter	5
L		NIEDZIELSKI, Michael	10
LEUNG, Abraham	15	P	
	3, 11,	PAN, Haixiao	7, 17
	12, 15,	PAN, Qisheng	17
LEVINSON, David	16, 18	PANDE, Anurag	13
LI, Hongchang	7	PATEL, Chetan	6
LI, Shengxiao	2	PEREIRA, Mauro	9
LI, Tiebei	11	PETERS, Sebastian	12
LI, Wei	13	PIATKOWSKI, Daniel	4

2017 World Symposium on Transport and Land Use Research
 July 3-6, 2017 - Brisbane, Australia

POLLARD, Gregory	10	VIJ, Akshay	12
PONCE LOPEZ, Robeto	11	VISWANATH, Kalpana	18
PONGPRASERT, Pornraht	13	W	
PRASAD, CSRK	2	WANG, Donggen	3, 17
PYROHOVA, Svitlana	12	WANG, Zhanyong	6
R		WASFI, Rania	5
RALPH, Kelcie	4	WEIDMANN, Ulrich	5
RANSOM, Michael R.	4	WENJIA, Zhang	12
RIVERA, Roselle Leah K.	18	WESTERDAHL, Stig	3
ROBERTO BONGULTO, Jose	15	WIGGINTON CONWAY, Matthew	2
RONG, Chaohe	7	WINTER, Karin	12
ROITMAN, Sonia	16	WITLOX, Frank	4, 13
ROSE, Geoff	10	WOLDAY, Fitwi	10
S		WRIGHT, Steven D.	3
SALDARRIAGA, Juan	10	WU, Amy	17
SAXE, Shoshanna	2	WU, Wei	11
SCANZE, Michele	12	X	
SCHEURER, Jan	15	XU, Meng	11
	5, 9, 10,	XU, Wangtu	7
SCHNEIDER, Robert	15, 18	Y	
SCHWANEN, Tim	4	YANG, Jie	3
SHAW, Jingsi	11	YEN, Barbara T.H.	4, 11, 16
SHEARER, Heather	4	YILDIRIMOGLU, Mehmet	3
SHEKAR LOKKU, Prashanth	2	Z	
SPRUMONT, François	9		12, 15,
STEFANICH, Joseph	5	ZHANG, Ming	16, 17
STĘPNIAK, Marcin	10	ZHANG, Yi	11
STOJANOVSKI, Todor	5	ZHANG, Yina	7
STRAND, Arvid	12	ZHAO, Jian	17
T		ZHAO, Pengjun	2
TANG, Jia	16	ZHEN, Feng	16
TANKO, Michael	6, 13	ZHONG, Ming	17
TERMIDA, Nursitihazlin Ahmad	6	ZHONG, Shaopeng	11
TIMMERMAN, Richard	4	ZHOU, Meng	3
TRINH LE, Diem	11	ZHU, Jing	4
TSAI, Yu-Hsin	4	ZUIDGEEST, Mark	10, 12
TSITSI TAMUKA MOYO, Hazvinei	12	ZUPAN, Jeffrey	10
V			
VALE, David	9		
VAN EGGERMOND, Michael	2, 9		
VIANA, Claudia	9		

ORGANIZING COMMITTEE

International Organizing Committee

- João de Abreu e Silva, Instituto Superior Técnico, Conference Co-Chair
- Robert Schneider, University of Wisconsin-Milwaukee, Conference Co-Chair
- Geneviève Boisjoly, McGill University
- Jason Cao, University of Minnesota
- Yingling Fan, University of Minnesota
- Ahmed El-Geneidy, McGill University
- Emily Grisé, McGill University
- David Levinson, University of Sydney
- Arlene Mathison, University of Minnesota
- Corinne Mulley, University of Sydney

Local Organizing Committee

- Matthew Burke, Griffith University
- Neil Sipe, University of Queensland
- Mark Hickman, University of Queensland

Theme Leaders

- João de Abreu e Silva, Instituto Superior Técnico
- Dan Chatman, University of California, Berkeley
- Kelly Clifton, Portland State University
- Ahmed El Geneidy, McGill University
- Dick Ettema, Utrecht University
- Yingling Fan, University of Minnesota
- Joel Franklin, KTH Royal Institute of Technology
- Erick Guerra, University of Pennsylvania
- Susan Handy, University of California, Davis
- David Levinson, University of Sydney
- Iderlina Mateo-Babiano, University of Melbourne
- Corinne Mulley, University of Sydney
- Meead Saberj, Monash University
- Robert Schneider, University of Wisconsin-Milwaukee

See you at Portland, Oregon 2020!